

DESIGN
BUILD
OPERATE

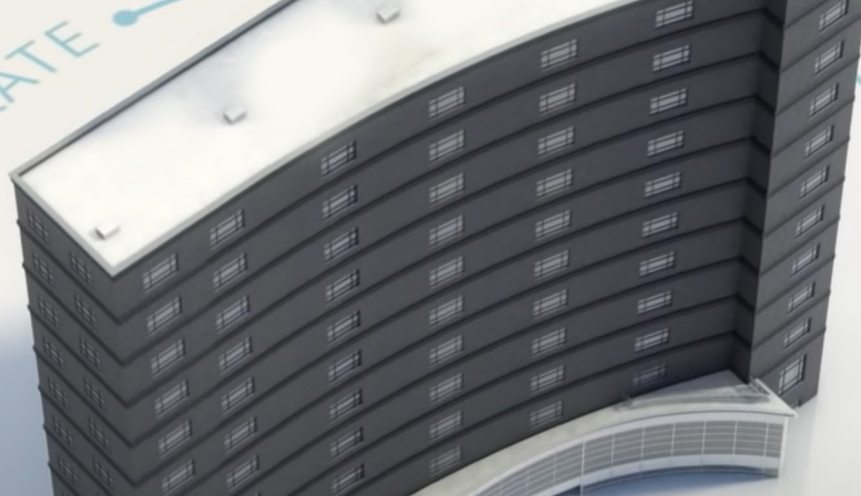

THE 21ST CENTURY DEMANDS SECURITY- FIRST SPACES

DEVELOPERS MUST PRIORITIZE SECURITY IN THE PLANNING PHASE

In today's connected world, electrical, plumbing, HVAC and transportation solutions are integrated into a building's infrastructure during the development process – long before construction begins.

It's time for developers to add access control and video surveillance technology to that list, so that securing both a projects' operation and the wellbeing of future occupants are core design elements.

For nearly 50 years, Kastle has custom-designed access control and video surveillance solutions for the unique needs of thousands of clients. Our decades of experience give us a uniquely authoritative perspective on the best ways to integrate these building technology systems in the most efficient and effective, but least invasive, ways possible. Our innovative and proprietary consultation process begins well before construction documentation and bidding. It saves our customers time and money by avoiding change orders and on-site modifications while improving the facility's long-term functionality.

Kastle's extensive expertise ensures a building is well-secured and prevents the need for costly construction change orders late in the building process. It guarantees the use of best-in-class technology and solutions instead of off-the-shelf hardware "retro-fitted" onto a building design as an afterthought.

KASTLE'S ADVANCED "BEFORE THE POUR" TECHNOLOGY DESIGN PROCESS IS:

- 1** No obligation up-front security consultation, analysis, and planning at no extra charge
- 2** Design development documents that illustrate the security technology plan as an integrated component of a building's structural, electrical, HVAC, elevator and parking design
- 3** Decades of experience securing a diverse range of buildings
- 4** No cost to the developer until Kastle's system is selected and implemented
- 5** Delivering a smooth experience for tenants and residents
- 6** Creating an end-to-end security design built to last



CASE STUDY: **DISTRICT WHARF**

The District Wharf, a mixed-use development from Hoffman & Associates, located in Washington, D.C., includes businesses, retail, restaurants and residences.

Kastle began designing the security infrastructure during the schematic phase, putting safety at the core of the development. Our work guaranteed that the project's security technology was integrated with the other infrastructure systems – electrical, HVAC, mechanical, plumbing and structural – from the start.

Kastle's early involvement helped make the project delivery a resounding success. The technology has helped the development become a vibrant addition to the urban character of the Washington DC waterfront without an overt visual presence of security technology – it's a design that works to enhance the user experience. It's all based on a simple goal – to be an integral partner in achieving the developer's business goals while keeping spaces safe for occupants and operators.

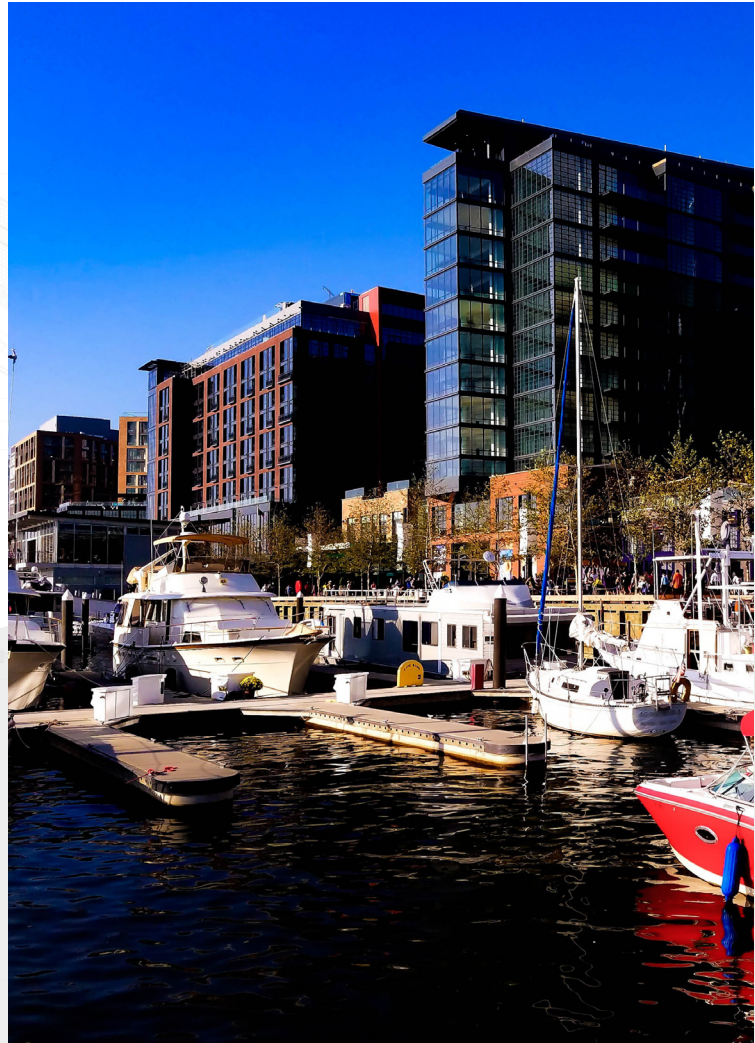

We started working with Kastle 12 months before we broke ground on The Wharf Phase 1 project. Thanks to our collaboration – and their expertise – we stayed on-time and on-budget, a miracle for a project of this size.

Monty Hoffman
Hoffman and Associates